

LAMP® Mono Flat Door Hardware FAD-20 for Medium-Weight Doors Instruction Manual

Thank you for selecting our product. Before starting installation, please read this manual thoroughly to ensure correct installation. Please keep this manual at hand for future reference.

ABOUT THE PRODUCT

- Lateral opening system for a medium size cabinet.
- Doors swings out laterally in a small radius compared to ordinary swing doors, ideal for tight space application.

SPECIFICATIONS

Cabinet inner width	500 to 550 mm
Max. Cabinet inner height	2420 mm
Max. Door thickness	35 mm
Max. Door weight	20 kg/door

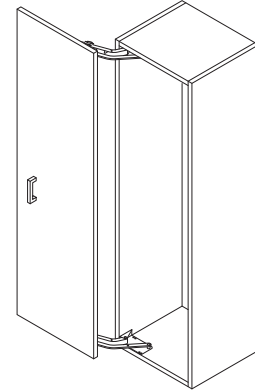

FOR YOUR SAFE WORK AND CORRECT INSTALLATION

Meaning of symbols



! Caution: If not followed injury or damage may result.

- ! It is necessary to manufacture the frame with sufficient strength so that it endures the weight of the door and any impact upon opening/closing the door. Only use designated screws and ensure that they are fastened firmly. A cabinet with poor strength or loose screws might result in the door falling and causing injury.
- ⊘ Do not try to use this product for anything other than its original purpose. Do not use any part for applications outside of its specification.
- ! Make sure to follow the dimensions measurements and specifications as well as horizontal and vertical angles. Make sure that the frame is not warped, since it may affect the movement of the door.
- ! This product is a part for furniture fittings. After installation, make sure to test the finished product thoroughly to ensure that it is well-functioning and safe.
- ! Make sure to test the screws for slack at regular intervals (one month from first usage, half a year, and then one time every year is recommended).

COMPONENT PARTS

① Arm A 1 pc. 	② Arm B 1 pc. 	③ Connecting pipe 1 pc.
④ Upper bracket 1 pc. 	⑤ Lower bracket 1 pc. 	⑥ Pipe clamp 2 pcs.
⑦ Cap 2 pcs. 	⑧ Bind head tapping screw 4.5X20 22 pcs. 	⑨ Bind head screw M5X8 4 pcs.
⑩ Hexagon socket head cap screw M4X8 4 pcs. 	⑪ Countersunk head tapping screw 4.5X20 2 pcs. 	⑫ Sticker 1 pc.

INSTALLATION DRAWING (EXAMPLE) (Unit : mm)

- The below figures show the installation of a left handed door. A right handed plan view would be bilaterally symmetric with the left handed door, while a right handed elevation view would be rotationally symmetric.
- The positions of the screw holes in the upper/lower brackets are determined from the cabinet's inner edge. When determining the screw hole positions from the door edge consider overlay when determining the positions.

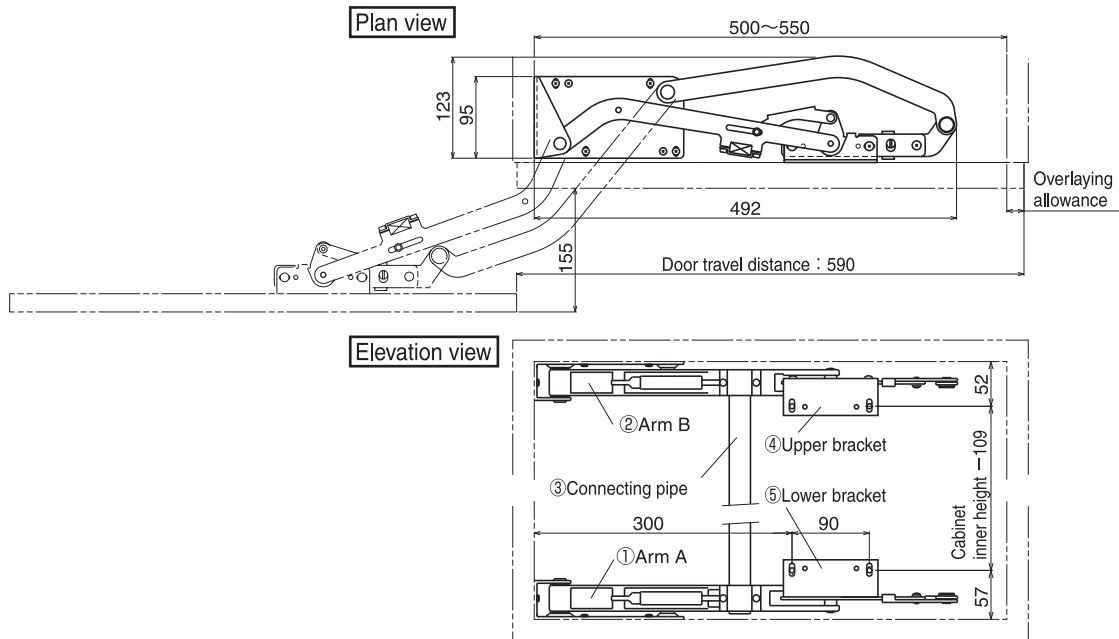

INSTALLATION PROCEDURE

This describes the installation of a left-handed door.

1 Installing arm A to the bottom of the cabinet

- Fit the base bracket of arm A to the cabinet side panel. Then position the bracket 5 mm away from the front end of the cabinet bottom panel.
- Fix the base bracket to the cabinet side panel first, then fix the rest of the three elongated holes with screw ⑧.

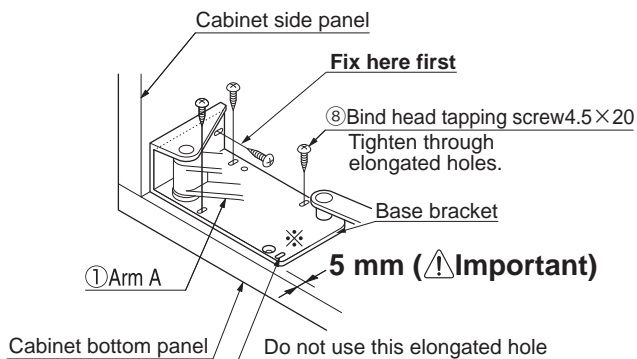

⚠ Caution

Be sure to fasten the screws firmly to prevent the bracket from coming off.

2 Installing arm B to the roof of the cabinet

- Secure arm B in the same way as arm A.

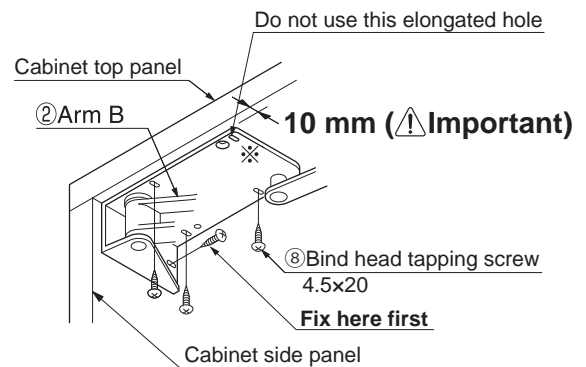

⚠ Caution

Be sure to fasten the screws firmly to prevent the bracket from coming off.

3 Installing the connecting pipe to the upper and lower arms

- [1] Cut the connecting pipe to a length of (cabinet's inner height – 25) mm.
- [2] Attach the caps to both ends of the pipe.
- [3] Fit the connecting pipe with the recess of the upper and lower arms, and fasten the pipe to the arms with the pipe clamps and screws ⑩ as shown in the figure.

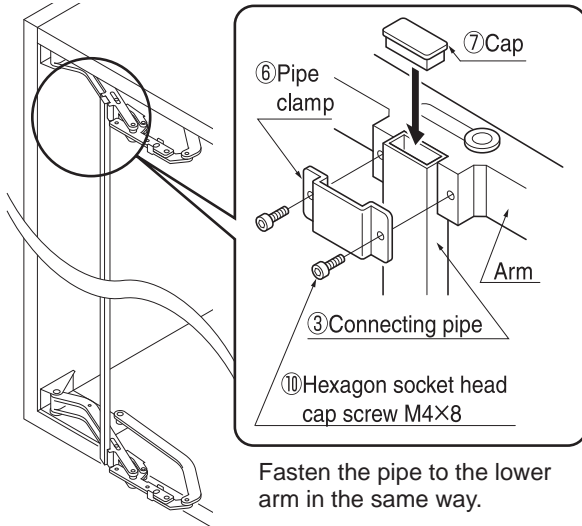

4 Installing the upper and lower brackets to the door

- Fasten the upper and lower brackets with four screws ⑧ (two for each bracket) through the two elongated holes in the larger face of each bracket. For the bracket mounting positions, see “Installation drawing” on page 2. The bracket positions can be adjusted vertically.

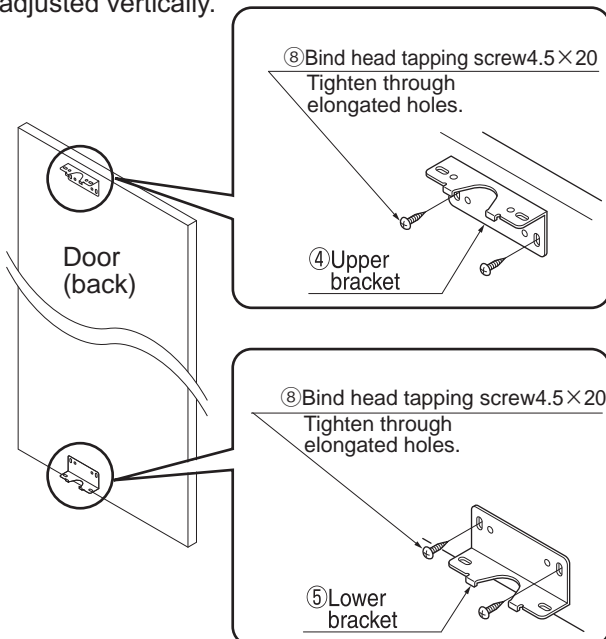

⚠ Caution

Be sure to fasten the brackets firmly to avoid them from coming off.

5 Installing the door to the upper and lower arms

- Insert the upper and lower brackets into the joints near the connecting pipe, match the screw holes, then fasten the brackets and joints with screws ⑨. The coupling positions can be adjusted later.

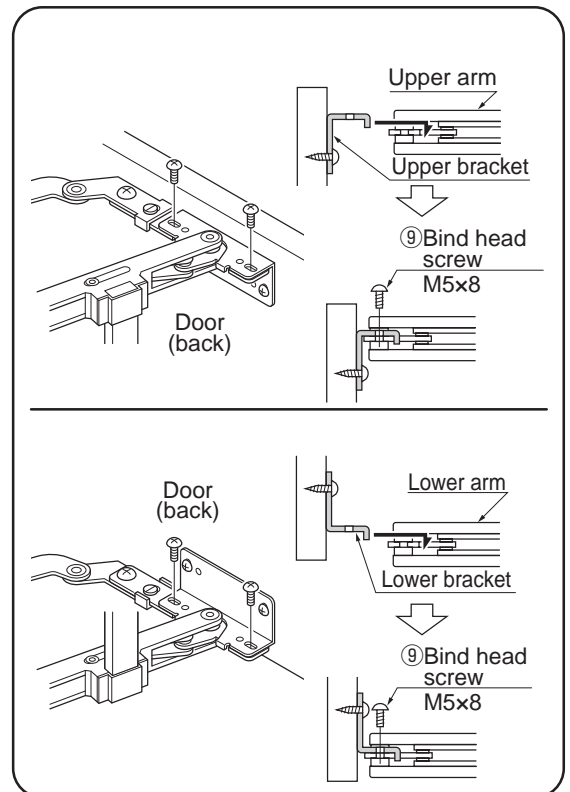
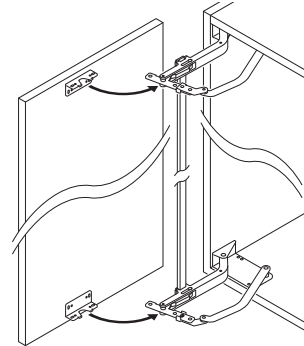

- If it is difficult to screw the upper fittings from above, screw the fittings from below.

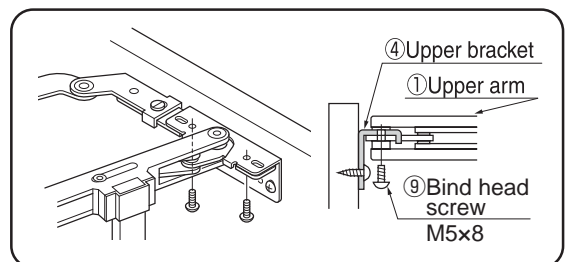

6 Door adjustments

Door position can be adjusted by shifting the positions of the arm brackets. Loosen the screws on the fittings and adjust the position, then re-tighten the screws.

● Front-back adjustments

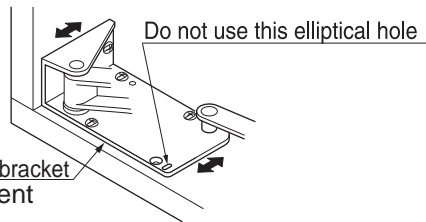

● Height adjustment

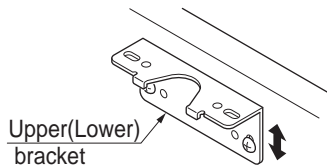

● Horizontal adjustment

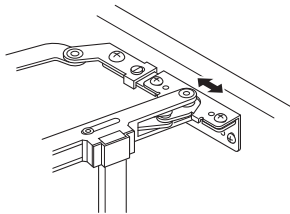

7 Adjusting the gap between the door and cabinet.

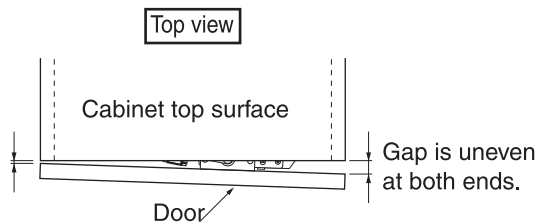

[1] Loosen fixing screw

[2] Turn adjusting screw

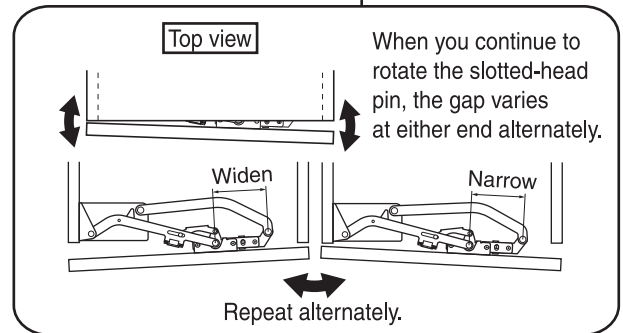
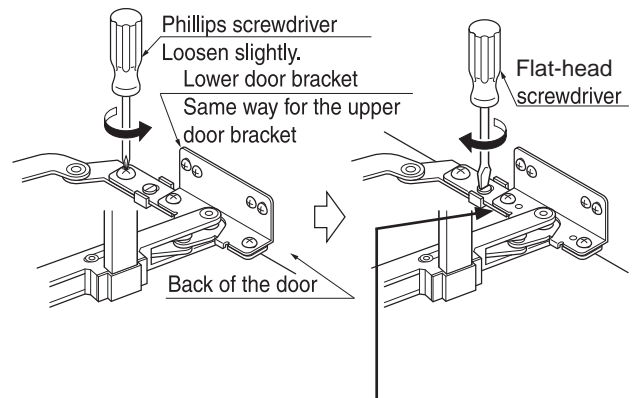

8 Final fixing of brackets(upper/lower)

[1] Re-tighten existing screws firmly.

[2] Fix the brackets with below mentioned screws.

Base brackets

Upper(Lower) bracket

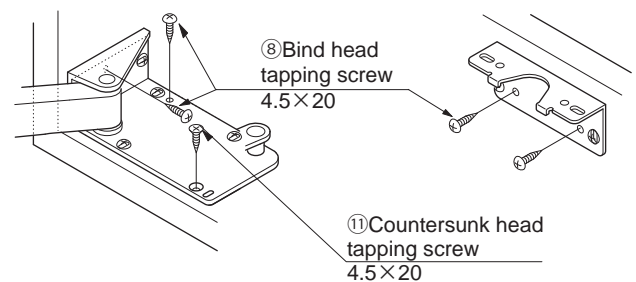

9 Installing a handle (not included) to the door

※Be sure to mount the handle to a location closer to the base brackets than the center of the door.

SUGATSUNE KOGYO CO.,LTD
Tokyo, JAPAN
Phone: +81 (0)3 3866 2260 E-mail:export@sugatsune.co.jp

SUGATSUNE KOGYO (UK) LTD
Reading, UK
Phone: +44 118 9272 955 E-mail:sales@sugatsune.co.uk

SUGATSUNE EUROPE GmbH
Düsseldorf, GERMANY
Phone: +49 211 53812900 E-mail:sales@sugatsune.eu

SUGATSUNE SHANGHAI Co., LTD
Shanghai, CHINA
Phone: +86 21 3632 1858 E-mail:lamp@sugatsune.com.cn

Guangzhou, CHINA
Phone: +86 20 6639 3552 E-mail:lamp@sugatsune.com.cn

SUGATSUNE KOGYO INDIA PRIVATE LIMITED
Mumbai, INDIA
Phone: +91 22 28314490/91 E-mail:sales@sugatsune.in

SUGATSUNE AMERICA, INC
California, USA
Phone: +1 310 329 6373 E-mail:sales@sugatsune.com

Chicago, USA
Phone: +1 312 461 1081 E-mail:chicagoshowroom@sugatsune.com.

SUGATSUNE CANADA, INC.
Phone: +1 514 312 5267 E-mail:support@sugatsune.ca

ISO9001(Japan Offices and Sugatsune America) and ISO14001(Chiba Production division and Logistics center), certified.

2018.08 0374-6