

# LAMP® FOLDING POCKET DOOR SYSTEM ALT-F Installation Manual

Thank you for selecting our product. Before starting installation, please read this manual thoroughly to ensure correct installation. Please keep this manual at hand for future reference.

## ABOUT THE PRODUCT

- Pocket door hardware for folding door systems.
- The folding door can be stored inside shallow cabinets.

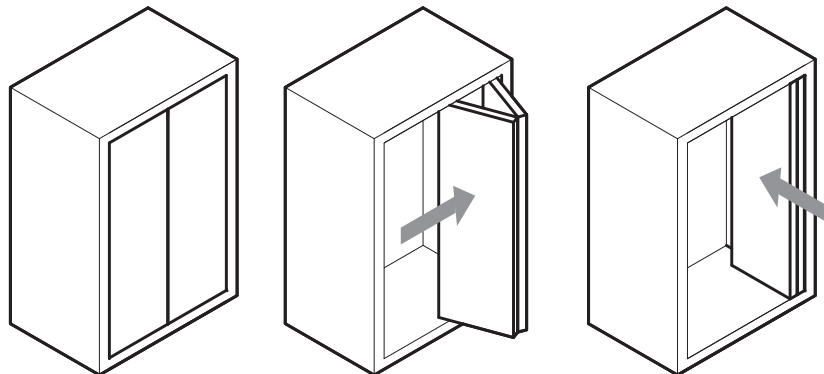

## SPECIFICATIONS

	2 Rail System	3 Rail System
Max. door width	450 mm / door	
Max. door height	1830 mm	1831 - 2400 mm
Door thickness	23 - 30 mm	
Max. door weight	10 kg / door	

## FOR YOUR SAFE WORK AND CORRECT INSTALLATION

### Meaning of symbols

 <b>Warning Caution</b>	 <b>Prohibited</b>	 <b>Required</b>
--	---	---

### **Warning : If not followed, death or serious injury may result.**

- ❗ Provide a cabinet that can withstand the weight and impact of opening and closing the door. Be sure to use the specified screws and tighten them securely. If the mounting strength is insufficient, the door may fall and cause injury.
- ⊘ Do not use this product for any other purpose, or with doors that are outside the specifications of this manual.
- ⊘ Do not disassemble or modify any parts other than those described in this document.

### **Caution : If not followed injury or damage may result.**

- ❗ This product should be installed by a qualified person in accordance with this manual. If it is not installed correctly, the door may fall and cause injury.
- ❗ Follow the specified dimensions, specifications, and alignment of the cabinet. Warping, tilting or twisting of the cabinet or door may cause failure.
- ❗ If cutting any parts, make sure to remove any burrs before installation. Also check the upper rail for any left-over burrs or scraps and remove these.
- ❗ This product is a part for furniture. After installation, please check the function and safety of the final product. Please inform the end user how to use the product safely.
- ❗ Make sure to check the screws for slack at regular intervals (one month from first usage, half a year, and then one time every year is recommended).



# INSTALLATION DRAWINGS

This shows the right-hand opening type.  
Installation for the left-hand opening type should be reversed.

Item Name	Opening direction	Rail Length (A)	Door Storing	Cabinet Depth (B)
ALT-F18LV2	Left	460.4	345.9 + Door thickness	466.7 + Door thickness
ALT-F18RV2	Right			
ALT-F20LV2	Left	511.2	396.7 + Door thickness	517.5 + Door thickness
ALT-F20RV2	Right			
ALT-F18LV3	Left	460.4	345.9 + Door thickness	466.7 + Door thickness
ALT-F18RV3	Right			
ALT-F20LV3	Left	511.2	396.7 + Door thickness	517.5 + Door thickness
ALT-F20RV3	Right			

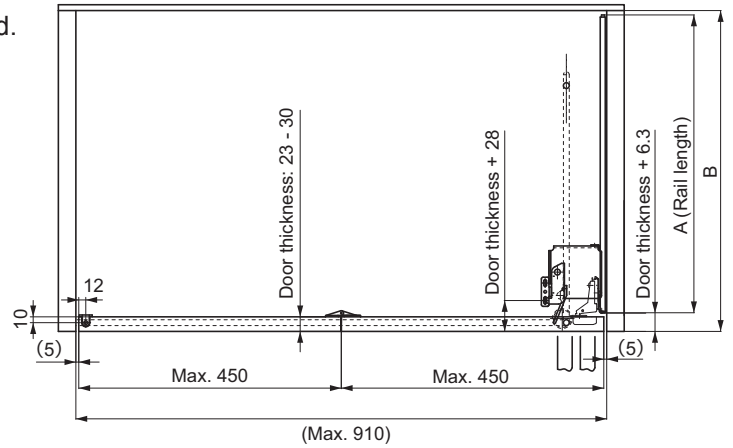

## Installation Drawing (3 Rails Type)

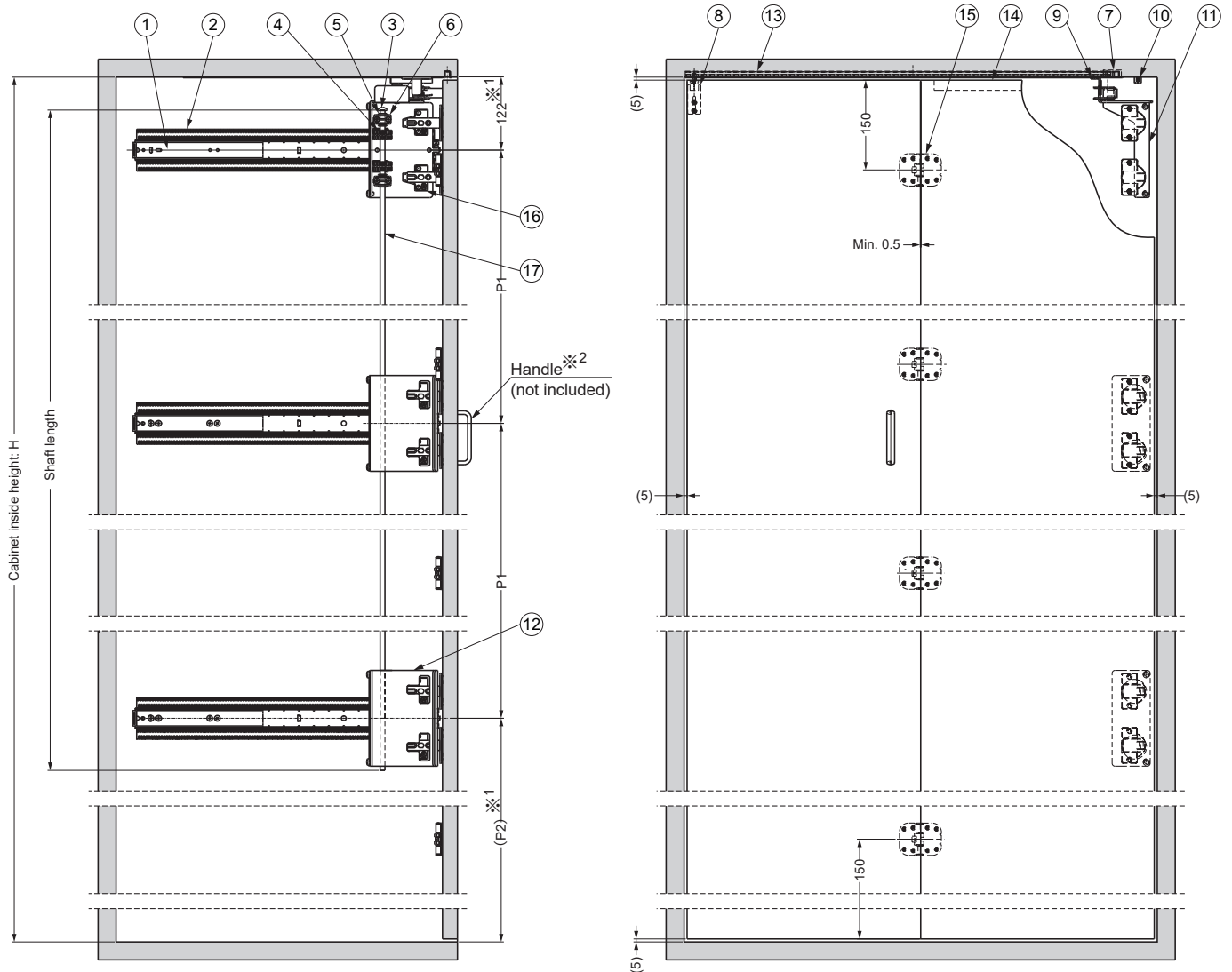

※<sup>1</sup> Position of rails

The dimension of the design is 125, but take into consideration that the door may sag when installing the door.

※<sup>2</sup> Position of handle

See page 4 when placing a middle board.

	2 Rails Type	3 Rails Type	
Door Height	Max. 1830	1831 - 1903	1904 - 2400
Cabinet Inside Height: H	Max. 1840	1841 - 1913	1914 - 2410
Shaft Length	H-110		1803
P1	H-250	(H-250)/2	831
(P2)	128		H-1784

# CABINET DIMENSION

Use hardwood for core material where parts are installed.

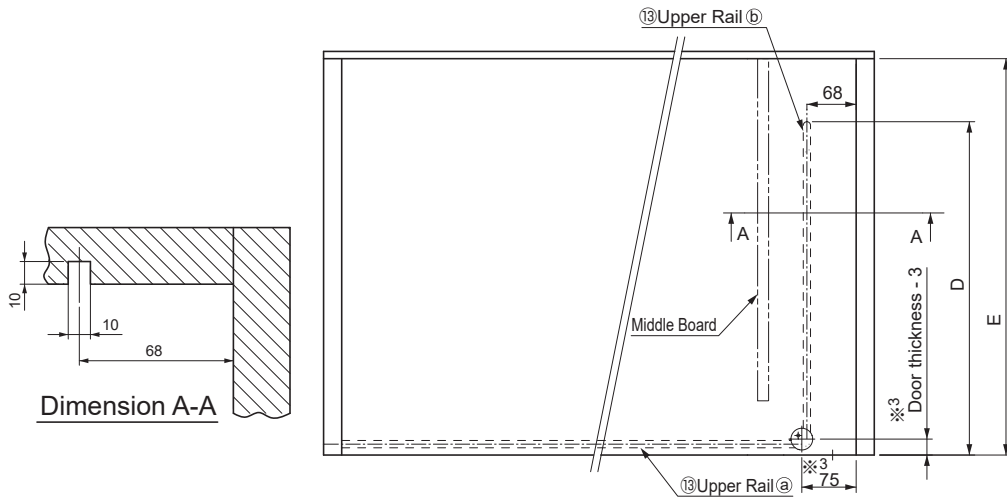

※<sup>3</sup> : Position (center) of  $\phi 30$  hole

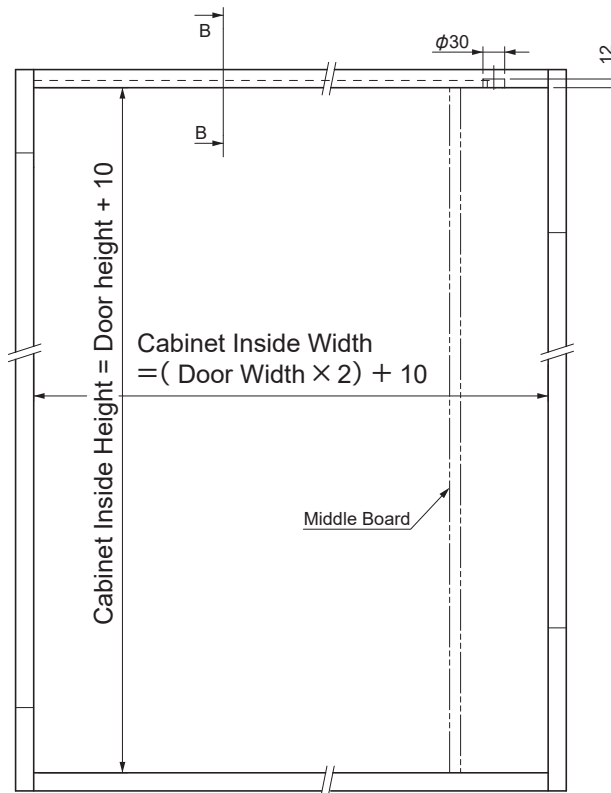
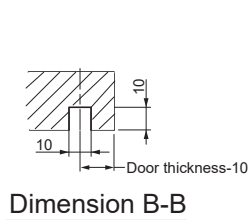

When installing middle board  
Position middle board to avoid  
interference with handle and angle  
stopper.

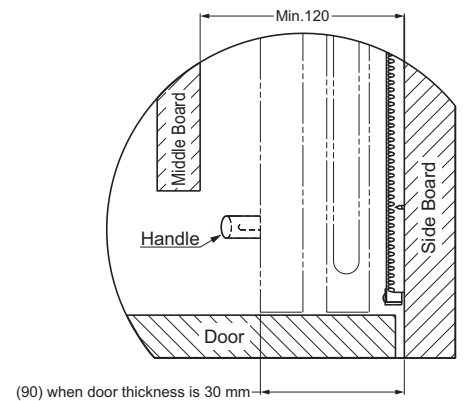

Length of Upper Rail ⑬

	Rail (a)	Rail (b)	D	E
ALF-F18(L/R)	Door Width × 2 - 69	375	410	Min. 466.7 + Door thickness
ALF-F20(L/R)		425	460	Min. 517.5 + Door thickness

Please drill a new hole within 50 mm from the end of upper rail after cutting the rail.  
Do not deform the rail when cutting.  
Deburr the cut surfaces.

# DOOR DIMENSION

Use hardwood for core material where parts are installed.

## [1] 2 Rails Type

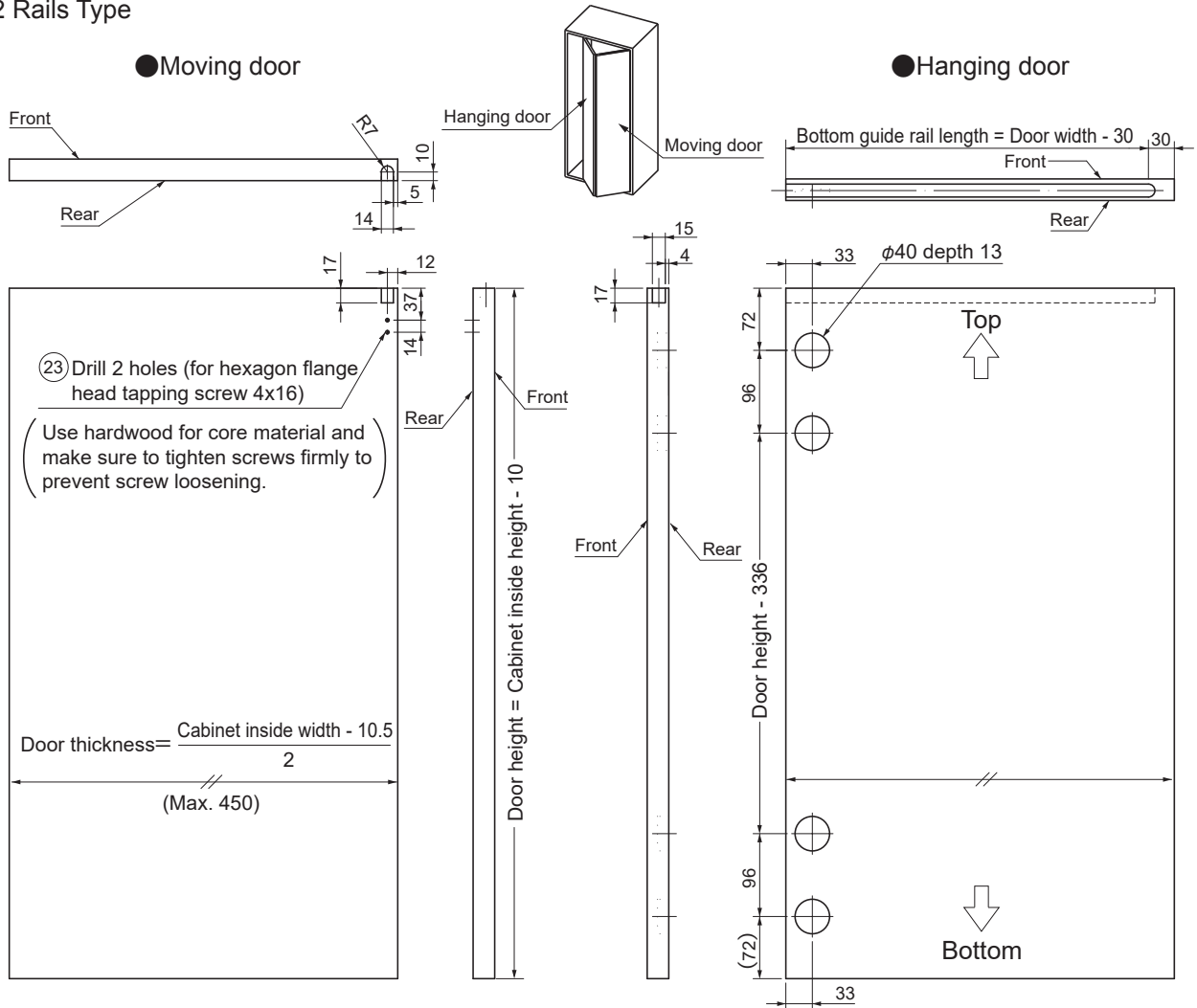

## [2] 3 Rails Type

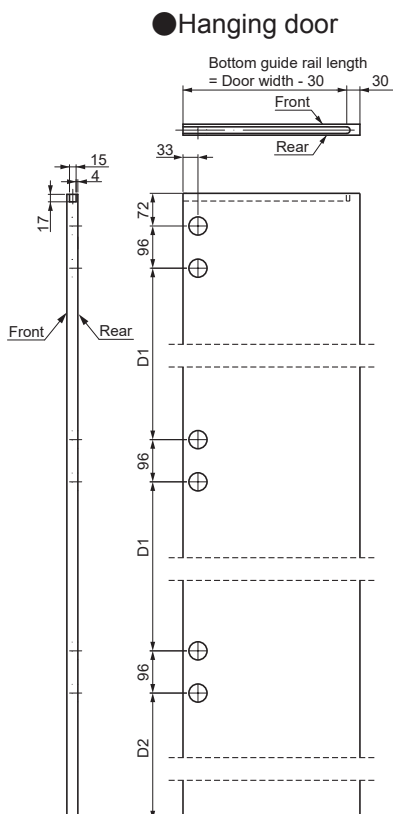

※<sup>4</sup> Please drill a new hole within 50 mm from the end of rail after cutting the rail.

Do not deform the rail when cutting.

Deburr the cut surfaces.

Door height	1831 - 1903	1904 - 2400
Cabinet inside height: H	1841 - 1913	1914 - 2410
D1	$(\text{Door height} - 432)/2$	735
(D2)	(72)	Door height - 1830

# INSTALLATION PROCEDURES

## 1 Installing Parts on the Top Board

Install parts in order of ① to ⑥.

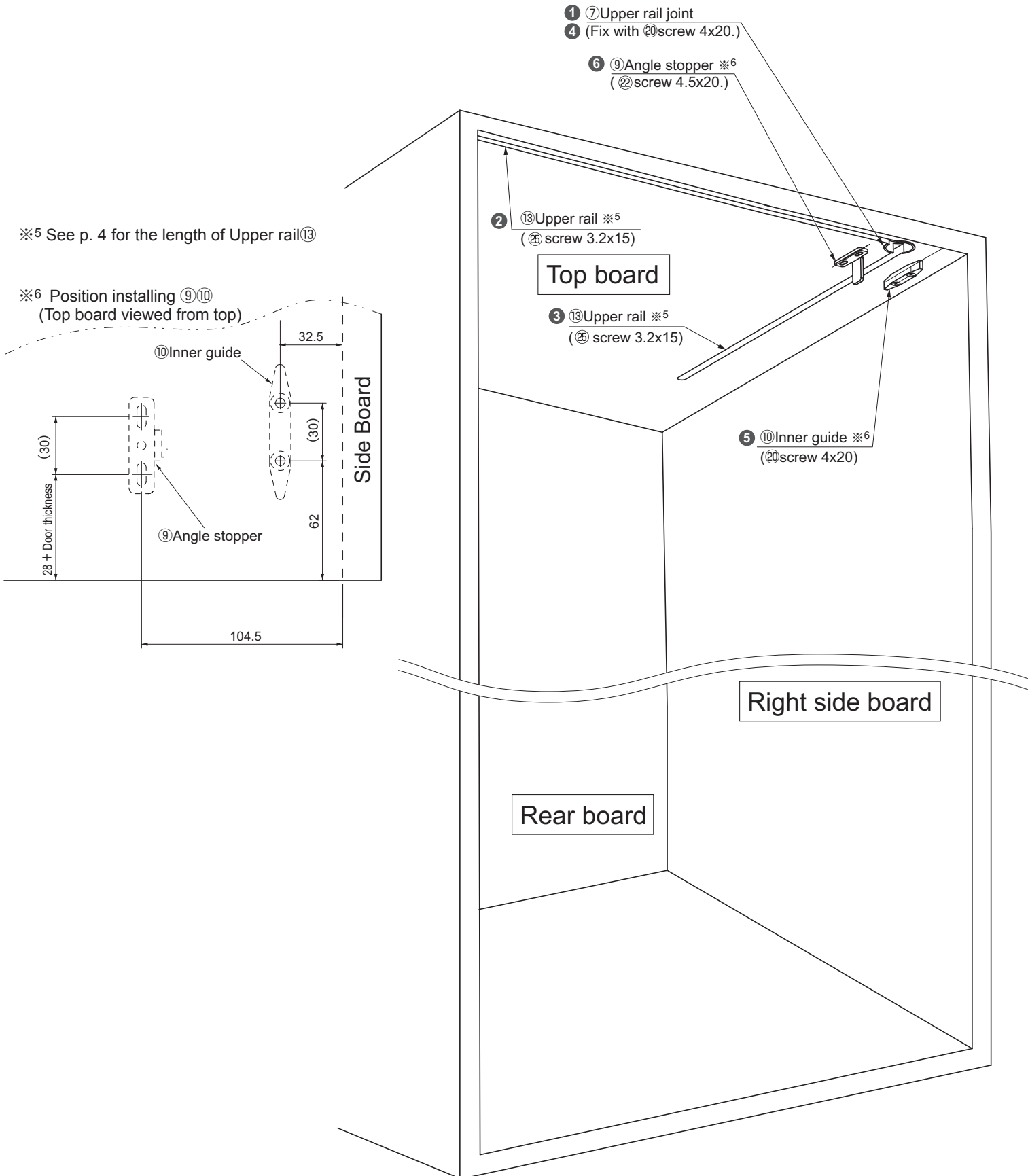



### 3 Assembling Interlock to Rail

Assemble interlock (11) to rail (1) with screw (21).

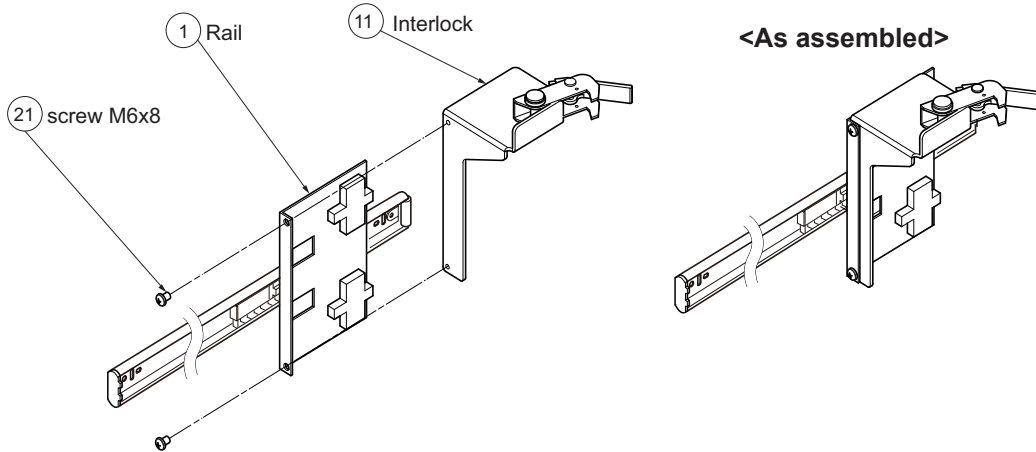

### 4 Installing Rails and Racks

#### 1 Positions for rails

##### [1] 2 Rails Type

##### [2] 3 Rails Model

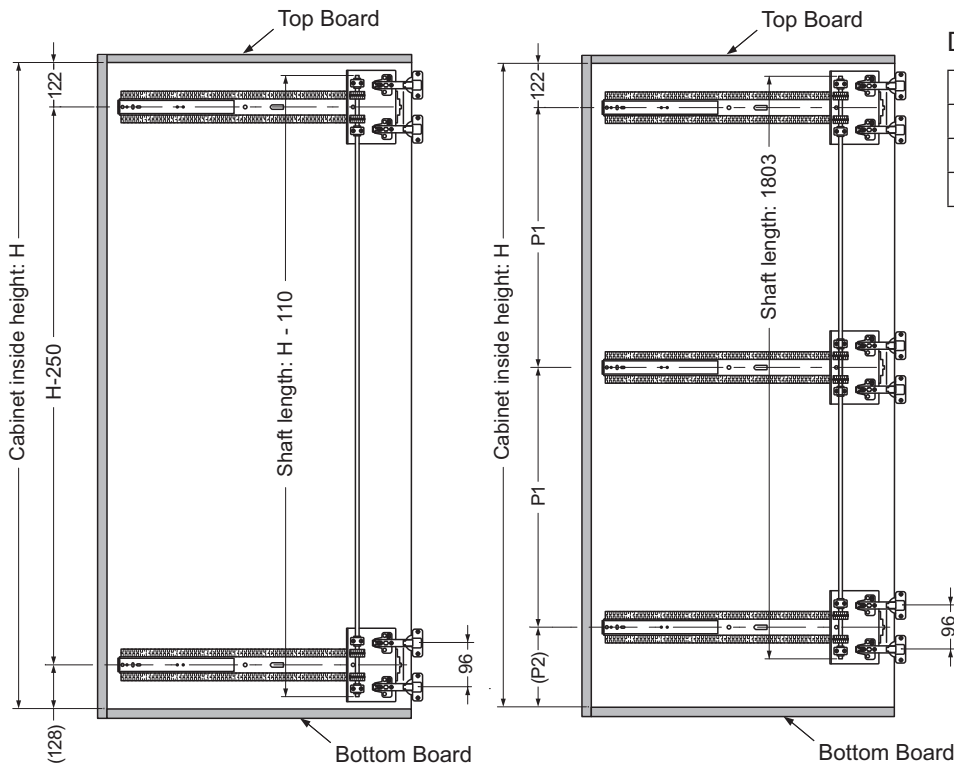

#### Dimensions for 3 rails model

Door height	1831 - 1903	1904 - 2400
Cabinet inside height: H	1841 - 1913	1914 - 2410
P1	$(H-250)/2$	831
(P2)	128	H-1784

#### 2 Fit rail to the rack.

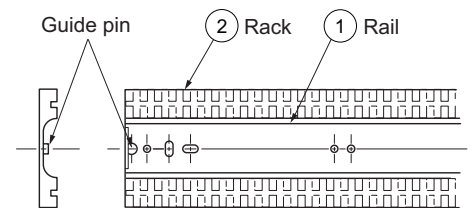

#### 3 Fixing Rails

Fix rails in order to be parallel each other.

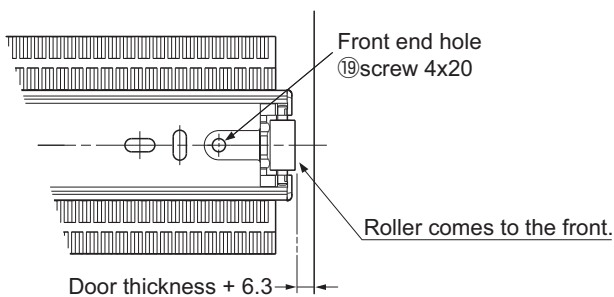

#### 4 Cutting of shaft

Cut shaft (17) as in above drawings.

#### CAUTION

1 Debur the cut surfaces of the shaft completely.

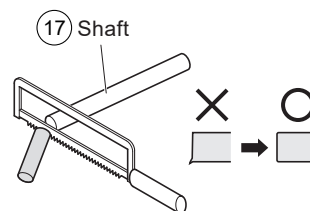



## 5 Assembling Shaft and Gear

- [1] If the shaft has been cut, remove burrs from the end of the shaft so that other parts can be easily installed.
- [2] Temporarily assemble the gears, shaft, and bushes as shown in the right figure; make sure that the top and bottom are correct.
  - ※ If the gears are facing in the wrong direction, they will not mesh with the rack.
  - ※ If the bush does not slide on smoothly, use more force to slide it on.
- [3] Push the cap firmly onto the shaft.

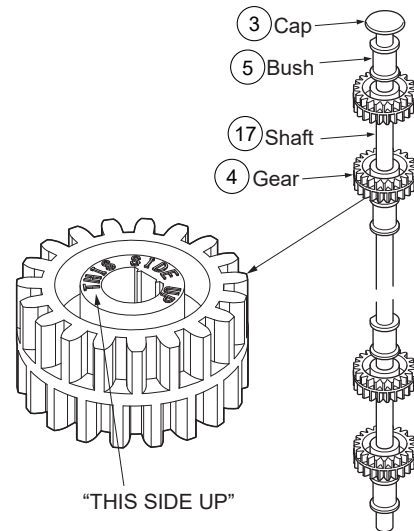

### ⚠ CAUTION

- ⊘ Do not use the shaft as a splice. This will adversely affect the movement of the door.

## 6 Assembling Gear into Rail

- (1) Pull the rail bracket to the end of the rail.
- (2) Engage the rack and gear of connecting shaft. Fix the stationary block as in below drawing.

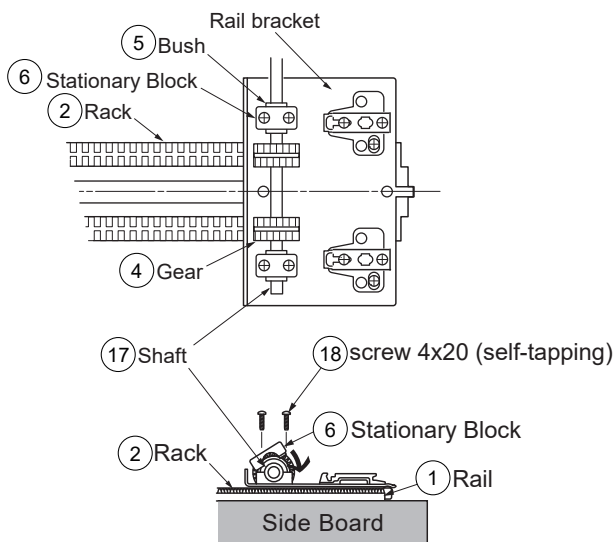

<Shaft mounted on the rail>

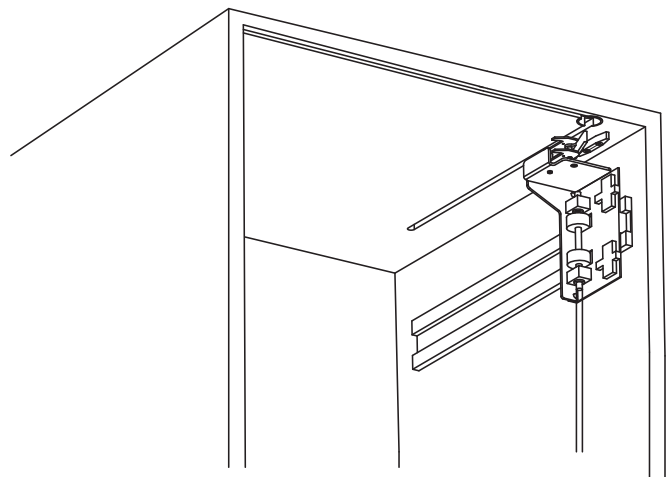

## 7 Hanging Doors

- ❗ The work of hanging the doors must always be carried out by a team of two workers.
- Install the door to mount the hinge set onto mounting plates.
- See **9** for door adjustment instructions.

### ⚠ CAUTION

- ❗ Do not adjust the screws farther than they turn easily. Over-turning may cause damage to the product.
- ❗ As for the vertical and depth adjustment, be sure to tighten the screws after the adjustment.

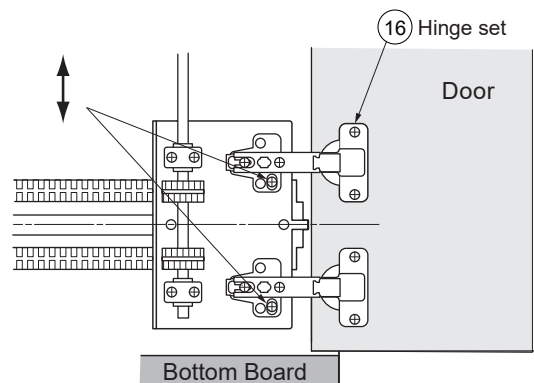

Height adjustment

## 8 Installing End Guide

Insert the end guide ⑧ into upper rail ⑬ and fix with ⑳ and ㉑ after height adjustment.

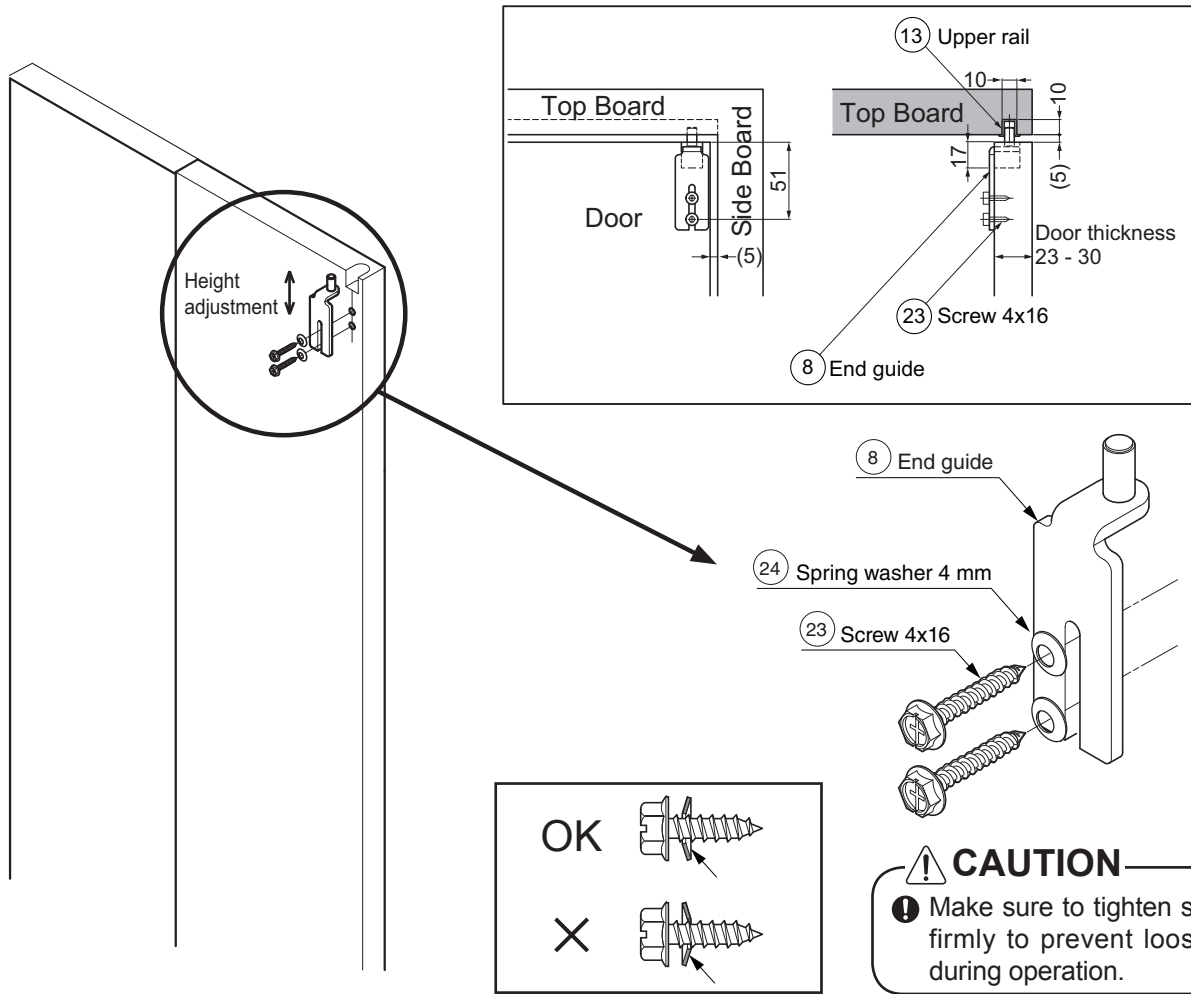

## 9 Adjusting Doors

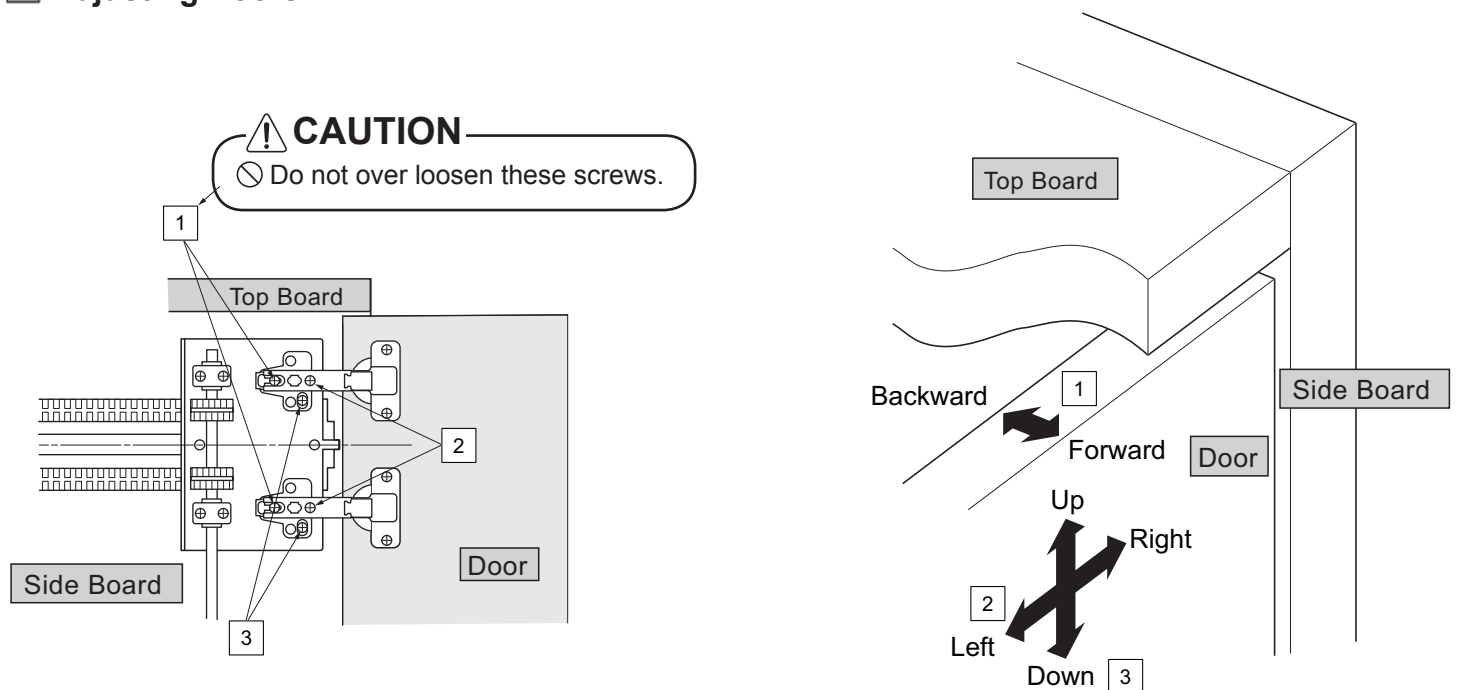

## 10 Assembling Hinge Cover Bracket

Assemble hinge cover bracket ⑫ to rail ①.  
(As for 3 slides model, assemble it to middle rail, too.)

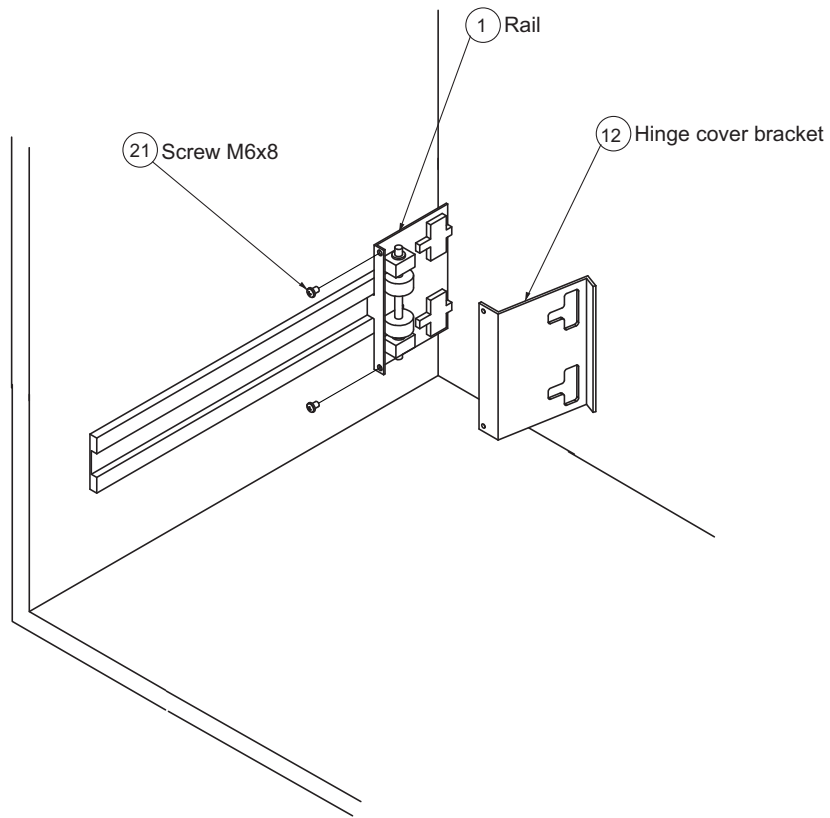

<Hinge cover bracket as assembled>

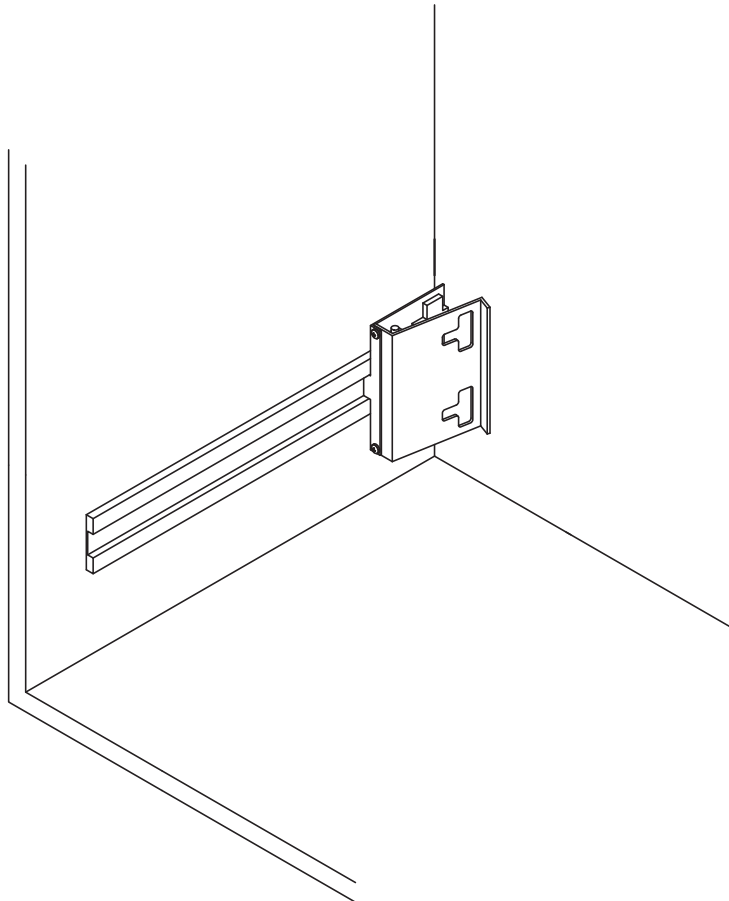

---

**SUGATSUNE KOGYO CO.,LTD****Tokyo, JAPAN**

Phone: +81 (0)3 3866 2260 E-mail:export@sugatsune.co.jp

**SUGATSUNE KOGYO (UK) LTD****Reading, UK**

Phone: +44 118 9272 955 E-mail:sales@sugatsune.co.uk

**SUGATSUNE EUROPE GmbH****Düsseldorf, GERMANY**

Phone: +49 211 53812900 E-mail:sales@sugatsune.eu

**SUGATSUNE SHANGHAI Co., LTD****Shanghai, CHINA**

Phone: +86 21 3632 1858 E-mail:lamp@sugatsune.com.cn

**Guangzhou, CHINA**

Phone: +86 20 6639 3552 E-mail:lamp@sugatsune.com.cn

**SUGATSUNE KOGYO INDIA PRIVATE LIMITED****Mumbai, INDIA**

Phone: +91 22 28314490/91 E-mail:sales@sugatsune.in

**SUGATSUNE AMERICA, INC****California, USA**

Phone: +1 310 329 6373 E-mail:sales@sugatsune.com

**Chicago, USA**

Phone: +1 312 461 1081 E-mail:chicagoshowroom@sugatsune.com.

**SUGATSUNE CANADA, INC.**

Phone: +1 514 312 5267 E-mail:support@sugatsune.ca