

Thank you for using our product.  
Before installation, please read this manual thoroughly to ensure correct installation.  
Please keep this manual at hand for future reference.

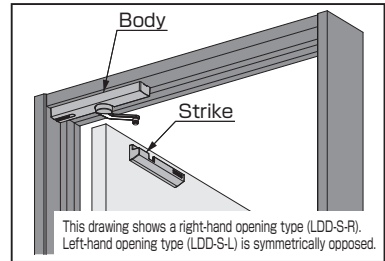

## About the product

An indoor-use door damper for opening doors, which can be retrofitted onto existing doors.  
Highly installable with easy mounting position alignment.

## For your safety and correct installation

### Meaning of symbols

	<b>Warning</b> Caution		<b>Prohibited</b>		<b>Required</b>
--	---------------------------	--	-------------------	--	-----------------

Instruction movie

Troubleshooting

**⚠ Caution:** If not followed injury or damage may result.

- ⊘ This product is for indoor use only. Do not use outside or anywhere where it will be exposed to water.
- ❗ Depending on the hinge or latch used with this product, the door may not move properly.
- ❗ Follow the specified dimensions, specifications, and alignment of the door and frame. Warping, tilting or twisting of the frame or door may cause failure.
- ⊘ Do not use an impact screwdriver. It may damage the product.
- ❗ This product is a part for architectural fittings. After installation, please check the function and safety of the final product. Please inform the end user how to use the product safely.
- ⊘ Do not close the door with excessive force. It may cause damage.
- ❗ Under strong winds, the damper will be overloaded, so please close the door by hand under strong winds.
- ⚠ Ambient temperature range is 0 to 40°C. The closing speed of the door may vary due to the temperature. This is not unusual.

## Parts list

\*Right hand type (LDD-S-R) shown. Left hand type (LDD-S-L) symmetrically opposite.

No.	①	②	③	④
Product name	*LDD-S body	*Body cover	*Strike plate unit	*Strike plate cover
Parts				
Quantity	1	1	1	1

No.	⑤	⑥	⑦	⑧
Product name	Body installation screw (nominal 3.5×30)	Strike plate installation screw (nominal 4×16)	Template for strike plate	Instruction Manual (this manual)
Parts				—
Quantity	2	2	1	1

# Installation

Check each box as the task or verification is completed.

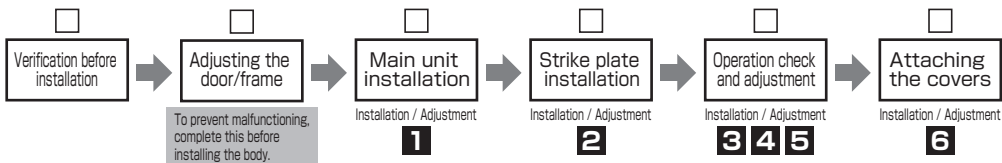

## Verification before installation

\*Inquire with Sugatsune for installation of dimensions other than those below.

### ■ Verification of door opening side/damper used

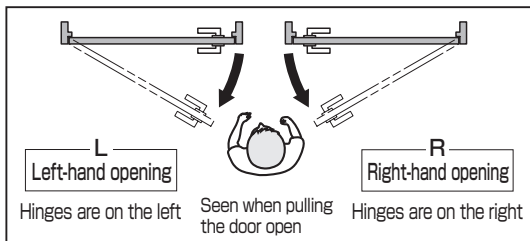

### ■ Applicable door specifications

Maximum door width	900 mm (36")
Door weight range	15 - 40 kg (33.6-88 lbs.)

### ■ Recommended hinges

Butt hinge (Dimension <b>D</b> must be 60 mm or less)
Concealed hinge
Pivot hinge (Center hung pivot hinge unusable)

### ■ Installation drawing (This drawing shows a right-hand opening type (LDD-S-R). Left-hand opening type (LDD-S-L) is symmetrically opposed.)

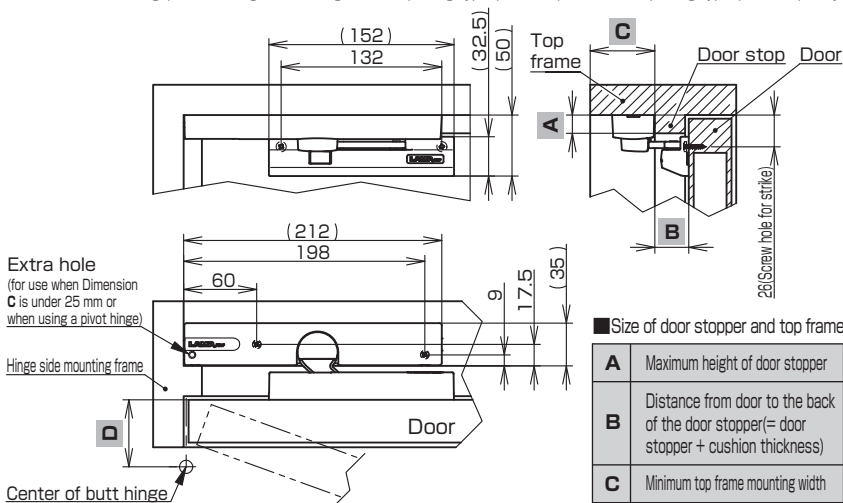

### ■ Size of door stopper and top frame (applicable size range)

<b>A</b>	Maximum height of door stopper	15 mm
<b>B</b>	Distance from door to the back of the door stopper (= door stopper + cushion thickness)	23 - 35 mm
<b>C</b>	Minimum top frame mounting width	20 mm

### ■ Verification of body mounting position (mounting position and mounting holes depend on the top frame mounting width (Dimension **C**) and the hinges used)

If **C** is 25 mm or more:

If **C** is between 20 mm and 25 mm / If Pivot hinge is used:

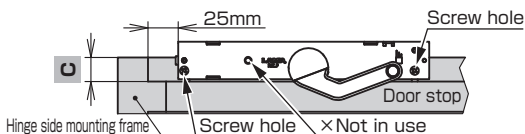
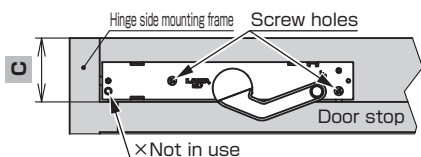

Line up the LDD-S body with the top door stop and hinge side mounting frame. Fix the body with the provided screws⑤.

Line up the LDD-S body with the top door stop and 25mm away from the hinge side mounting frame. Fix the body with the provided screws⑤.

When the top frame mounting width is narrow, drill a pilot hole as a countermeasure against splitting.

# Installation / Adjustment

## 1 Main unit installation procedure Begin after adjusting the door and frame setting.

1. In accordance with the "Verification of body mounting position" section, fix the body with screws.

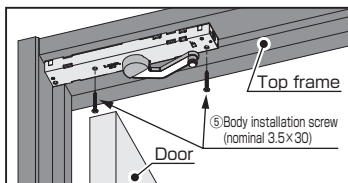

2. Pull the Arm out completely.

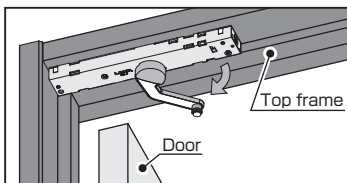

**Important**

Pull the arm out completely. If not pulled out completely, the damper will not function.

Confirm the Arm is completely pulled out.

## 2 Strike plate installation procedure Prepare the template for strike plate before beginning.

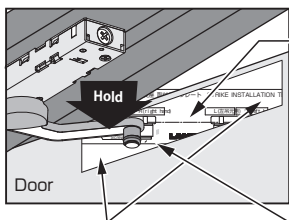

1. Adjust the template ⑦ so that it is parallel with the top of the door.

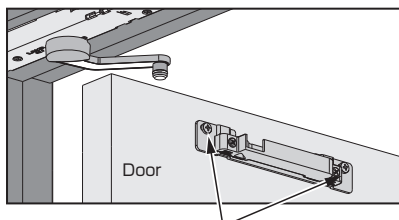

3. Mark the screw hole shown on the template.

2. Align the fully pulled out arm tip with the square hole.

4. Fix the strike plate with the screws ⑥ provided.

## 3 Operation check

1. Close the door slowly while holding the arm fully open and check the Roller enters into the guide groove.

\*If it does not fit, go on to "4 Strike plate adjustment."

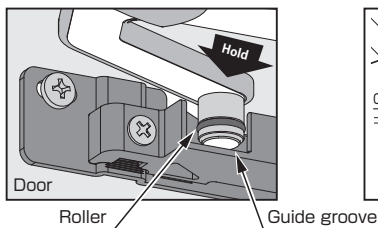

2. Check that the roller and guide groove clearance is within the range in the figure below.

\*If the clearance is outside the range, go on to "4 Strike plate adjustment."

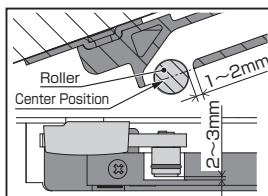

**Important**

Pull the arm out completely. If not pulled out completely, the damper will not function.

Confirm the Arm is completely pulled out.

3. Open and close the door several times in order to check proper function of the LDD-S.

\*If the arm returns when the door is opened, go on to "4 Strike plate adjustment."

\*If the door does not close fully, go on to "5 Closing power adjustment."

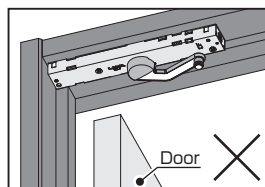
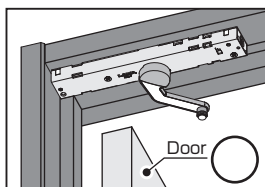

## 4 Strike plate adjustment

- If the roller does not fit into the strike plate guide groove ⇒ Adjust vertically and horizontally.
- If the arm returns when the door is opened ⇒ Move the strike plate toward the hinges, using the horizontal and vertical adjustment screws.

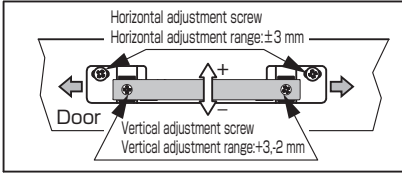

## 5 Closing power adjustment

- If the door does not close fully ⇒ Adjust with the closing power adjustment screw.
- \* Depending on the hinges and latch used, the door may not close fully even if adjusted.

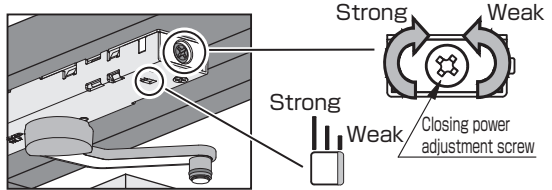

You can check the strength of the closing power with the indicator.

## 6 Attaching the covers Mount after adjustment.

1. Attach the covers for the main unit and the strike plate while keeping the door open.

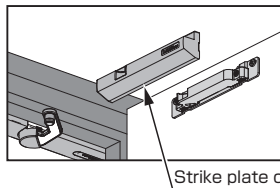
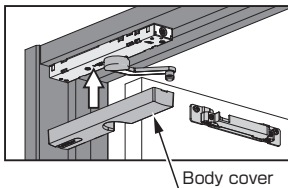

- Removing the covers  
With the door open, insert a flathead screwdriver, etc., in the cover notch and pull in the direction of the arrow.

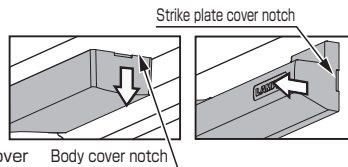

**Caution**  
Work with care so as not to scratch the door.

## Troubleshooting

Problem	Cause	Solution
Door does not close	Strike plate position is unsuitable	Refer to "4 Operation check" to check the position of the roller and guide groove, adjusting the strike plate so that the clearance is within the range.
Door does not close fully	Closing power is unsuitable	Refer to "5 Closing power adjustment" to adjust the closing power.
Body arm returns when door is opened	Strike plate position is unsuitable	Refer to "4 Operation check" to check the position of the roller and guide groove, adjusting the strike plate so that the clearance is within the range.

**SUGATSUNE KOGYO CO.,LTD**  
Tokyo, JAPAN  
Phone: +81 (0)3 3866 2260 E-mail:export@sugatsune.co.jp

**SUGATSUNE KOGYO (UK) LTD**  
Reading, UK  
Phone: +44 118 9272 955 E-mail:sales@sugatsune.co.uk

**SUGATSUNE SHANGHAI Co., LTD**  
Shanghai, CHINA  
Phone: +86 21 3632 1858 E-mail:lamp@sugatsune.com.cn

**Guangzhou, CHINA**  
Phone: +86 20 6639 3552 E-mail:lamp@sugatsune.com.cn

**SUGATSUNE AMERICA, INC**  
California, USA  
Phone: +1 310 329 6373 E-mail:sales@sugatsune.com

**Chicago, USA**  
Phone: +1 312 461 1081 E-mail:chicago showroom@sugatsune.com.

**SUGATSUNE EUROPE GmbH**  
Düsseldorf, GERMANY  
Phone: +49 211 53612900 E-mail:sales@sugatsune.eu

**SUGATSUNE KOGYO INDIA PRIVATE LIMITED**  
Mumbai, INDIA  
Phone: +91 22 28314490/91 E-mail:sales@sugatsune.in

ISO9001(Japan Offices and Sugatsune America) and ISO14001(Chiba Production division and Logistics center), certified.

**SUGATSUNE CANADA, INC.**  
Phone: +1 514 312 5267 E-mail:support@sugatsune.ca