



Thank you for using our product. Before installation, please read this manual thoroughly to ensure correct installation. Please keep this manual at hand for future reference.

⚠ Caution : If not followed injury or damage may result.

ⓘ Required **⊘ Prohibited**

- ⓘ Recommended ambient temperature range is 0°C - 40°C Do not use the product outside of this range.
- ⓘ Do not use on enclosures without sufficient strength. There is a risk of deformation or damage.
- ⊘ Do not disassemble nor modify the product.

ABOUT THE PRODUCT

- Damper for the adjustable spring loaded S-ATJ series stay.
- The lid closes in a soft motion.
- The damper is installed behind the stay so that it does not take up any storage space.

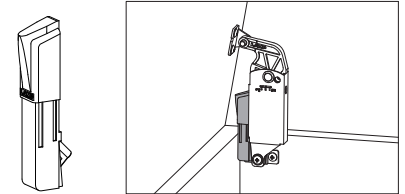

USABLE MODELS

Usable		Unusable
S-ATJ01	S-ATJ01D	S-ATJ01S
S-ATJ02	S-ATJ02D	S-ATJ02S
Sideboard	Backboard 28	Backboard 13

If S-ATJ stay is mounted outside of the recommended area, the damper may not work properly. Ask our sales staff for detail.

COMPONENT PARTS

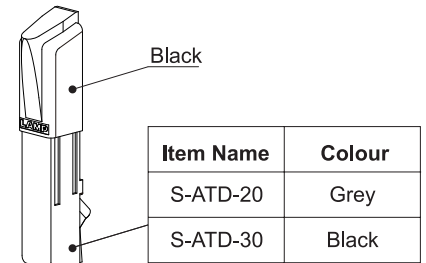

Item Name	Colour
S-ATD-20	Grey
S-ATD-30	Black

S-ATD damper : 1pc

ASSEMBLY

※Verify that there's no interference with adjacent parts before mounting.

1 Check if the shaft of the damper is set correctly.

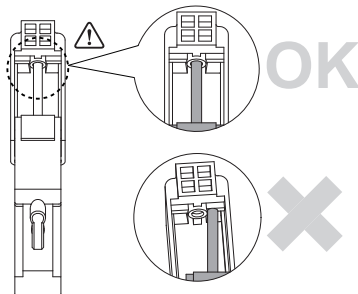

Back of S-ATD

2 Assemble S-ATD to S-ATJ.

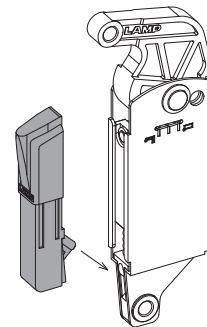

※Remove the stay from the brackets before assembling or removing S-ATD.

3 Mount S-ATJ to the brackets.

See the installation manual of S-ATJ for details. Check if the damper works properly after installation.

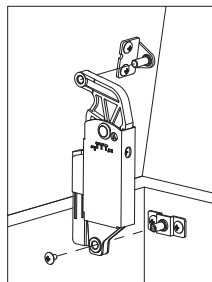

4 Lid motion adjustment.

The motion of the lid is adjustable by turning the adjustment screw.

①To make it faster:
(When the lid does not close completely.)

Turn the adjust screw counterclockwise.

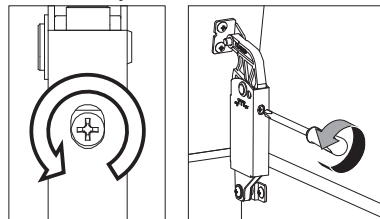

②To make it slower:
(When the lid slams.)

Turn the adjust screw clockwise.

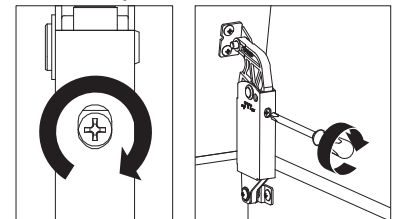

The above explanation is an example. See the installation manual of S-ATJ for the details.

SUGATSUNE KOGYO CO., LTD.
Tokyo, JAPAN
Phone: +81 3 3866 2260
E-mail: export@sugatsune.co.jp

SUGATSUNE KOGYO (UK) LIMITED
Reading, UK
Phone: +44 1189 272 955
E-mail: sales@sugatsune.co.uk

SUGATSUNE EUROPE GmbH
Düsseldorf, GERMANY
Phone: +49 211 53812 900
E-mail: sales@sugatsune.eu

SUGATSUNE AMERICA, INC.
California, USA
Phone: +1 310 329 6373
E-mail: sales@sugatsune.com

Chicago, USA
Phone: +1 630 317 7072
E-mail: sales@sugatsune.com

SUGATSUNE CANADA, INC.
Montreal, CANADA
Phone: +1 514 312 5267
E-mail: support@sugatsune.ca

SUGATSUNE SHANGHAI CO., LTD.
Shanghai, CHINA
Phone: +86 21 3632 1858
E-mail: lamp@sugatsune.com.cn

Guangzhou, CHINA
Phone: +86 20 6639 3554
E-mail: lamp@sugatsune.com.cn

SUGATSUNE KOREA CO., LTD.
Incheon, KOREA
Phone: +82 32 220 0603
E-mail: sales@sugatsune-korea.co.kr

SUGATSUNE KOGYO INDIA PRIVATE LIMITED
Mumbai, INDIA
Phone: +91 9867299597
E-mail: sales@sugatsune.in
Delhi, INDIA
Phone: +91 9867299597
+91 11 45093636
E-mail: sales@sugatsune.in