

# LAMP<sup>®</sup>

## DMF4-B BRACKET FOR DMF4 AND DMFH4 INSTALLATION MANUAL

Thank you for selecting our product. Before starting installation, please read this manual thoroughly to ensure correct installation. Please keep this manual at hand for future reference.

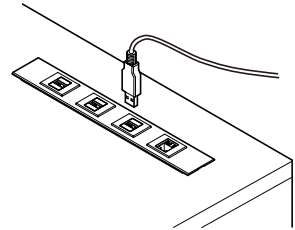

Cover is not included.

### ABOUT THE PRODUCT

- Mounting bracket for DMF4 and DMFH4.
- Various connectors such as LAN connectors, USB connectors, and enclosed type cable cases can be assembled.

### SPECIFICATIONS

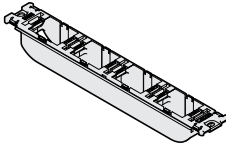

#### ■ Screw

Wood mounted : Binding head tapping screw 4×16···2 pcs (Included)

Metal mounted : Binding screw M4, Nut M4, and

Plain washers Nominal Size4 (Not included)

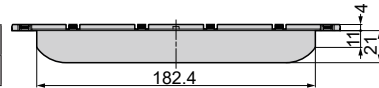
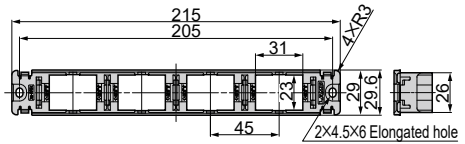

Item Code	Item name	Number of slots
210-046-311	DMF4-B	4

### PRECAUTIONS FOR SAFETY

#### Precautions for installation

**⚠ Caution** If not followed injury or damage may result.

- ❗ Ensure the product is installed in a place that can withstand the weight of the product, and the insertion and removal of connectors.

#### Precautions for use

**⚠ Caution** If not followed injury or damage may result.

- 🚫 Do not paint the product to avoid damage.

### INSTALLATION

#### 1 Drilling dimensions

**Surface mounted**  
For DMF4

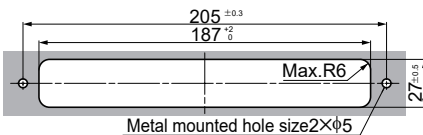

**Recessed mounted**  
For DMFH4

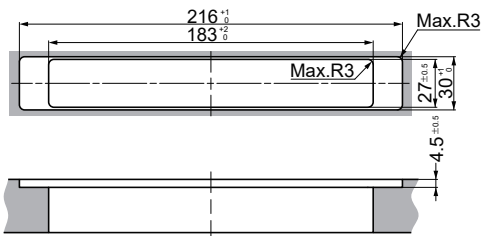

## 2 Assembly

[1]

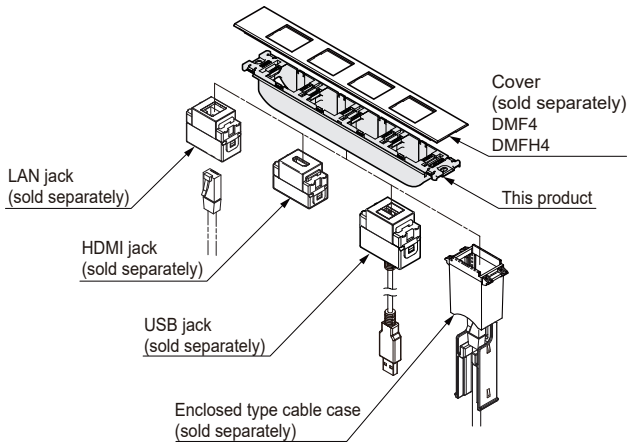

[2] Starting from either end, hook the jack onto the lip of the bracket and push until a click sound is heard.

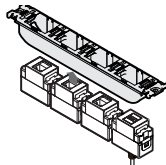

### Removal of jack

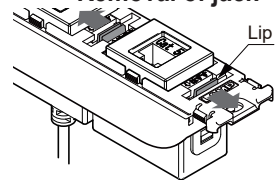

Remove bracket from furniture.

- ① Hold the jack.
- ② Pry either of the bracket lips away from the jack.
- ③ Remove the jack.

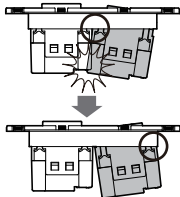

If there is interference with an adjacent component hook the jack claw on the opposite lip.

[3] Mounting.  
(For recessed mounted models)

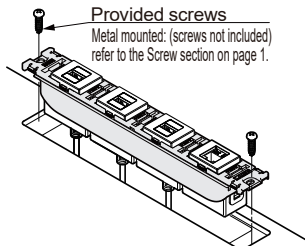

[4] Push the cover in until a click sound is heard, Leave no gap between the cover and tabletop.

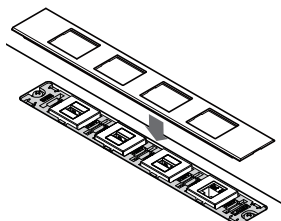

### Removal of cover

Insert a flat-head screwdriver into either of the gaps (●) between the cover and tabletop. Pry to remove the cover.

